

Y:\projects\bnr\20067130\_ga-ar-eda\dr-aw\ngs\working\_microstation\BNA-ROAD-GRDR.sht  
 2/25/2008 6:06:51 PM

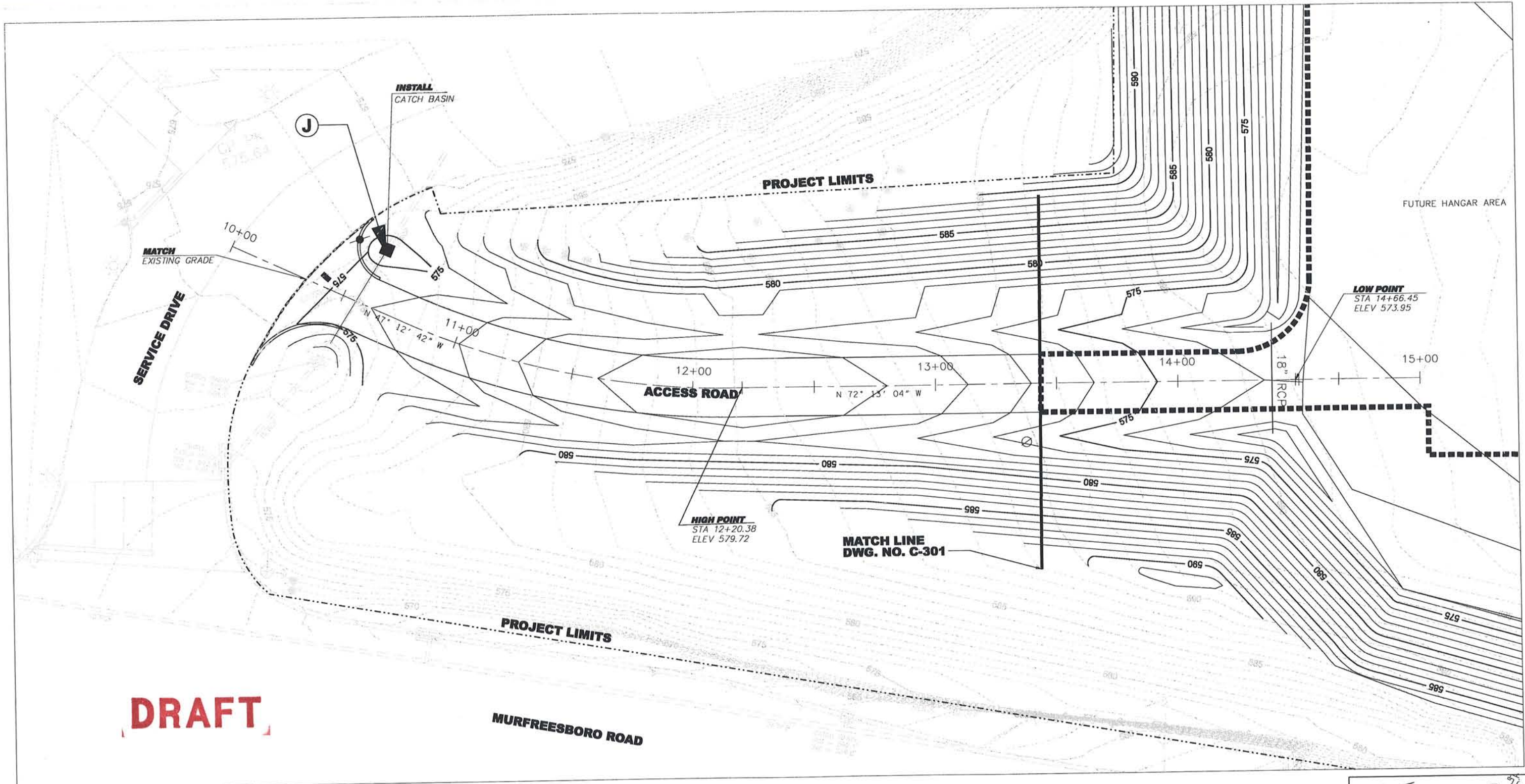

**NOTES:**

1. SEE DWG. NO. C-002 FOR ROADWAY ALIGNMENT
2. SEE DWG. NO. C-001 FOR DEMOLITION.
3. CONTRACTOR SHALL FIELD VERIFY EXISTING GROUND CONTOURS PRIOR TO COMMENCING EXCAVATION OR EMBANKMENT OPERATIONS.
4. PROPOSED CONTOURS REPRESENT EARTH CUT SLOPES. SEE DWG. NO. C-400 FOR REQUIRED ROCK CUT SLOPES IF ROCK IS ENCOUNTERED.

5. SEE DWG. NO. C-400 FOR ROADWAY TYPICAL SECTION.
6. SEE DWG. NO. C-006 FOR ROADWAY PROFILE.
7. SEE DWG. NO. C-301 FOR PIPE AND STRUCTURE TABLES.

**LEGEND**

- XXX --- EXISTING CONTOUR
- XXX --- PROPOSED CONTOUR
- --- BREAKLINE
- --- EDGE OF FUTURE PAVEMENT
- x - x - EXISTING FENCE
- - - - - PROJECT LIMITS

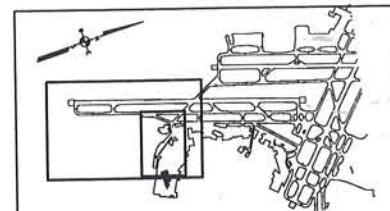

**KEY MAP**  
NOT TO SCALE

PROJECT NO:	20067130
DRAWN BY:	RMH
DESIGNED BY:	DLJ
CHECKED BY:	KTF
FILE NAME:	
DATE:	02/25/08
SCALE:	AS SHOWN
DWG. NO.	C-300
SHEET	21 OF 30

**ARMSTRONG.**  
1600 Westgate Circle / Suite 225  
Brentwood, TN 37027  
PH 615-377-1320 // FX 615-377-3630  
rwArmstrong.com

**NASHVILLE INTERNATIONAL AIRPORT**  
**METROPOLITAN NASHVILLE AIRPORT AUTHORITY**

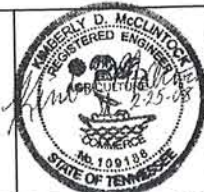

NO.	DATE	DESCRIPTION	APPROVED

**NASHVILLE INTERNATIONAL AIRPORT**  
**PROJECT NO. 0475 DEVELOP GENERAL AVIATION AREA SOUTH OF MURFREESBORO ROAD**  
**GRADING AND DRAINAGE PLAN - ACCESS ROAD**